

Conference Venue

Kitakyushu International Conference Center



Address: 3-8-1 Asano, Kokurakita-ku, Kitakyushu-shi, Fukuoka 802-0001

Website: <http://www.convention-a.jp/language/english.html>

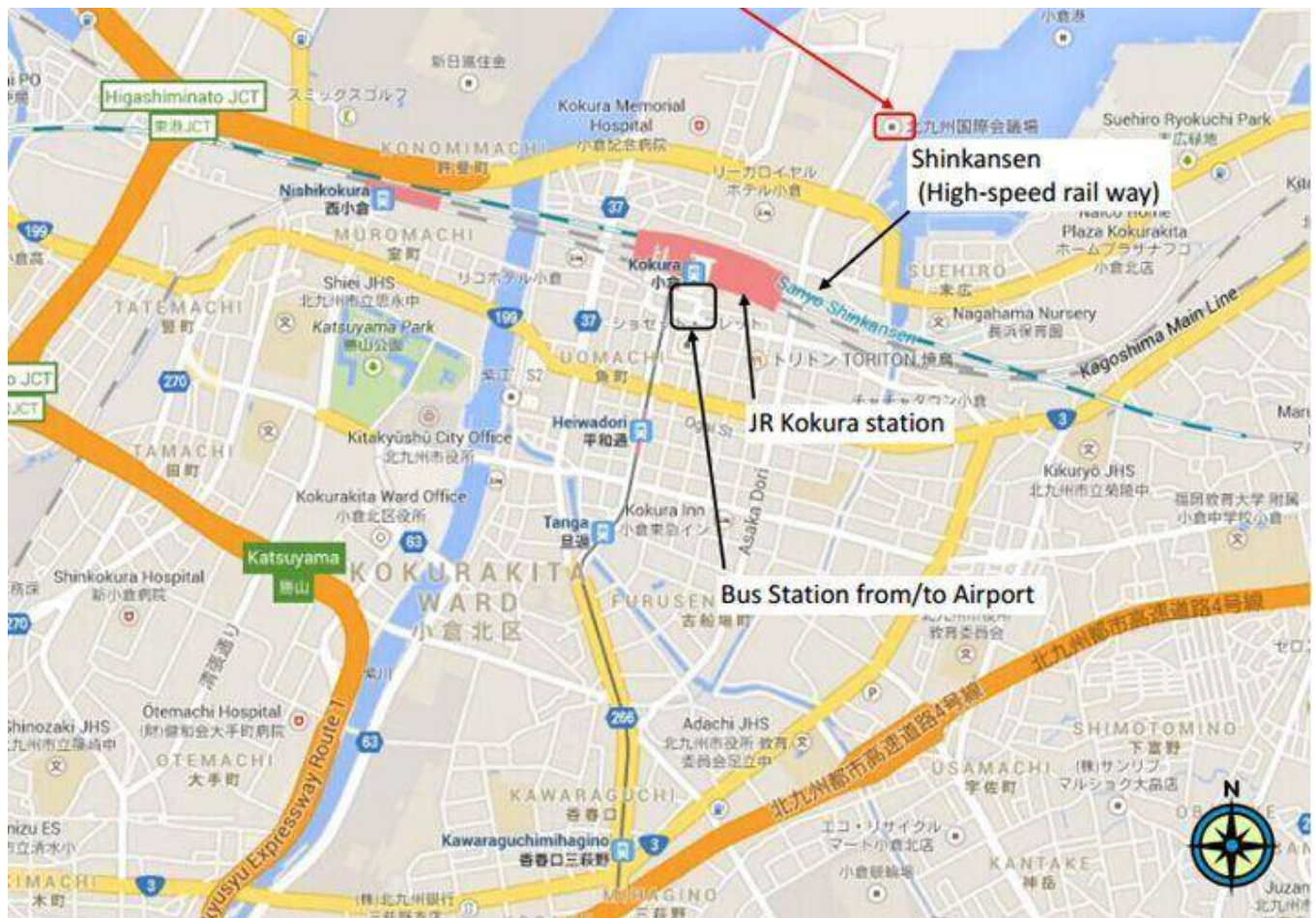

Conference Room Location

2nd Floor

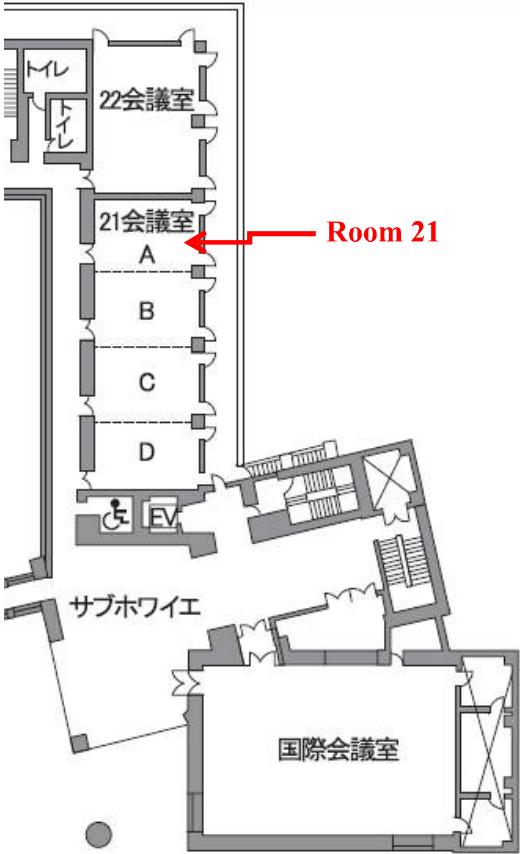

2F

3rd Floor

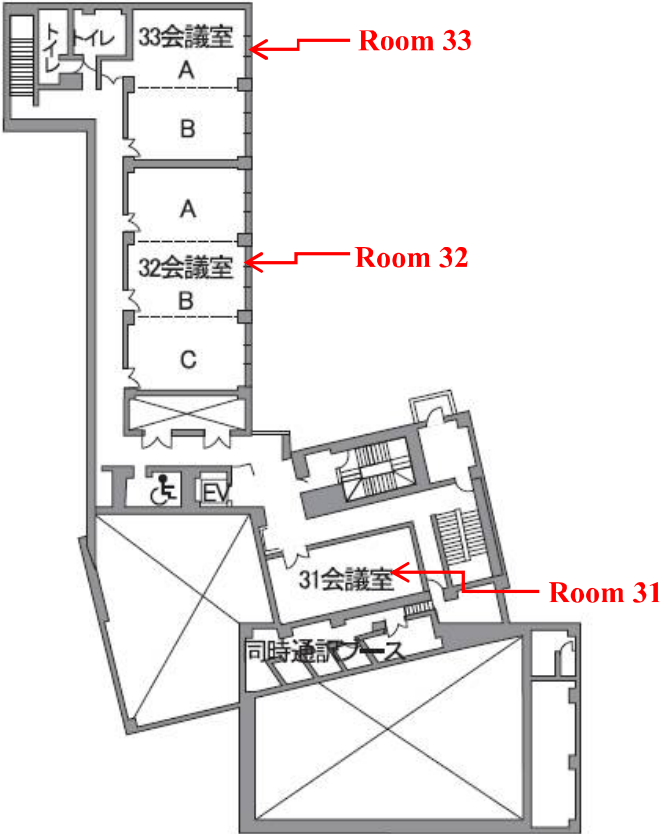

3F

HOW TO REACH THE CONFERENCE VENUE

📍 From Fukuoka International Airport(福岡空港) to JR Kokura Station(JR 小倉駅):

(a) By Highway Bus (Nishitetsu Highway Bus)

Take Nishitetsu Highway Bus at Domestic Terminal 2 or 3. If you arrive at International Terminal, move to Domestic terminal 2 or 3 using free "Shuttle Bus" between international and domestic terminals.

(b) By Subway (Fukuoka City Subway) and JR Train

- Firstly, take Fukuoka City Subway from Fukuoka Airport to JR Hakata Station(JR 博多駅). The airport station of Fukuoka City Subway "Fukuoka-kuko"(福岡空港) is in Domestic Terminal 2. If you arrive at International Terminal, move to Domestic Terminal 2 by taking free "Shuttle Bus" between international and domestic terminals.
- Buy a ticket from "JR Hakata Station(JR 博多駅)" to "JR Kokura Station(JR 小倉駅)" at "Train-Ticket Center" of JR Hakata Station. There are many trains from JR Hakata Station to JR Kokura Station. You can choose local train (about 100min), rapid service (about 70min) or express (about 45min). You can take the train of Kagoshima Honsen Line. Or buy a Shinkansen (bullet train) ticket from Hakata to Kokura (only 17 minutes). JR train fare ranges from 1,250 JPY to 2,200 JPY.

(c) By Taxi and Shinkansen (fastest but expensive)

- Firstly, take a Taxi from Fukuoka airport (international terminal) to JR Hakata Station(JR 博多駅). Single fare is about 1,000-2,000 JPY. Running time is about 10min.
- Buy a ticket of Shinkansen (Bullet train) from "JR Hakata Station(JR 博多駅)" to "JR Kokura Station(JR 小倉駅)" at "Train-Ticket Center" of JR Hakata Station. You can take Shinkansen "Nozomi", "Hikari" and "Kodama". Single fare is around 2,200JPY (non-reserved). Running time is about 25min.

📍 From Kitakyushu Airport(北九州空港) to JR Kokura Station(JR 小倉駅):

(a) Take airport bus from Kitakyushu airport to Kokura

(b) Take Taxi from Kitakyushu airport to Kokura

📍 From JR Kokura Station to Conference Center

Access from Kokura Station is 5-minute walk through a pedestrian deck.

